

THE ST. LOUIS
POST-GRADUATE
SCHOOL OF MEDICINE



POLYCLINIC AND HOSPITAL.

CORNER OF LUCAS AND JEFFERSON AVENUES.

1886-7.

Plan of First Floor.

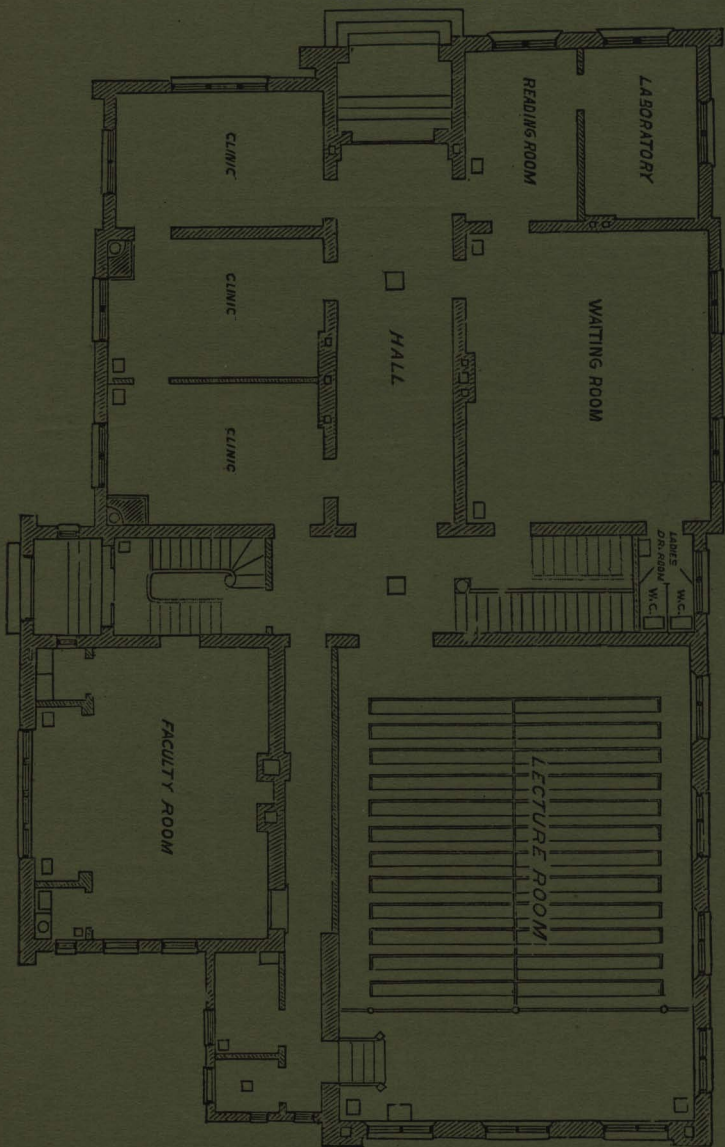

ANNUAL ANNOUNCEMENT

BOARD OF HONORARY TRUSTEES
OF THE

ST. LOUIS POST-GRADUATE
SCHOOL OF MEDICINE

POLYCLINIC AND HOSPITAL.

CORNER OF JEFFERSON AND LUCAS AVENUES.

Term begins Monday, October 25th, 1886, and ends

Saturday, July 2d, 1887.

1886-7.

RIVERSIDE PRINTING HOUSE, 302 N. MAIN STREET.

ANNUAL STATEMENT

BOARD OF HONORARY TRUSTEES.

JUDGE E. B. ADAMS.

REV. MARTIN S. BRENNAN.

DR. L. CH. BOISLINIERE.

MR. D. CRAWFORD.

DR. CHAS. O. CURTMAN.

MR. THOMAS DIMMOCK.

MR. JOHN T. DOZIER.

MR. BENJ. EISEMAN.

REV. WM. G. ELIOT, D. D.

MR. D. K. FERGUSON.

MR. WM. GLASGOW, JR.

*REV. C. L. GOODELL, D. D.

J. M. GOOD, PH. D.

DR. E. H. GREGORY.

MR. HENRY C. HAARSTICK.

REV. A. N. HOLLIFIELD, D. D.

REV. MR. KEILTY.

REV. PETER KITWOOD.

MR. F. N. JUDSON.

REV. FREDERICK LACK.

JUDGE G. A. MADILL.

DR. S. G. MOSES.

MR. N. O. NELSON.

DR. SYLVESTER NIDELET.

HON. HENRY OVERSTOLZ.

DR. THOS. O'REILLY.

DR. T. F. PREWITT.

REV. P. G. ROBERT.

MR. ENNO SANDER.

MR. E. C. SIMMONS.

MR. JOS. SPECHT.

JUDGE CHAS. SPECK.

MR. THOS. T. TURNER.

JUDGE J. G. WOERNER.

*Deceased.

FACULTY.

P. GERVAIS ROBINSON, M. D., LL. D., *Dean.*

PROFESSOR OF PRACTICAL MEDICINE AND THE PRINCIPLES OF DIAGNOSIS; Professor of the Practice of Medicine, Clinical Medicine and Hygiene, Missouri Medical College.

H. TUHOLSKE, M. D.

PROFESSOR OF SURGERY AND DISEASES OF THE GENITO-URINARY ORGANS; Professor of Clinical Surgery and Surgical Pathology, Missouri Medical College.

W. A. HARDAWAY, A. M., M. D.

PROFESSOR OF DISEASES OF THE SKIN; Clinical Professor of Dermatology, Missouri Medical College.

W. C. GLASGOW, A. B., M. D.

PROFESSOR OF DISEASES OF THE CHEST AND THROAT; Adjunct Professor of the Theory and Practice of Medicine, St. Louis Medical College; Physician to the Department of Chest and Throat, St. Louis Mullanphy Hospital.

H. N. SPENCER, A. M., M. D., *Treasurer.*

PROFESSOR OF DISEASES OF THE EAR, Consultant to the City Hospital.

CHAS. E. MICHEL, M. D.

PROFESSOR OF DISEASES OF THE EYE; Professor of Ophthalmology, Missouri Medical College.

A. J. STEELE, M. D.

PROFESSOR OF ORTHOPEDIC SURGERY AND DISEASES OF THE JOINTS; Attending Surgeon Department of Deformities and Joint Diseases, Augusta Free Hospital for Children; Professor of Orthopedic Surgery, Beaumont Medical College.

G. J. ENGELMANN, A. M., M. D., Berlin. *Master in Obstetrics, Vienna.*

PROFESSOR OF DISEASES OF WOMEN AND OPERATIVE MIDWIFERY; Consultant St. Louis Female Hospital.

H. W. HERMANN, M. D.

PROFESSOR OF DISEASES OF THE NERVOUS SYSTEM, AND ELECTROTHERAPEUTICS; Consulting Physician St. Louis Insane Asylum.

CHARLES E. BRIGGS, A. M., M. D., Harvard; *Secretary.*

PROFESSOR OF DISEASES OF CHILDREN; Physician to the House of the Good Shepherd.

CLINICAL ASSISTANTS.

DEPARTMENT OF GENERAL MEDICINE:

E. M. NELSON, M. D., Ph. D. J. R. LEMEN, M. D.

DEPARTMENT OF SURGERY AND GENITO-URINARY DISEASES:

C. H. DIXON, M. D. L. T. RIESMEYER, M. D.

DEPARTMENT OF DERMATOLOGY:

F. R. EVERSOLE, M. D.

DEPARTMENT OF CHEST AND THROAT:

L. C. BOISLINIERE, JR., M. D. J. R. HEREFORD, JR., M. D.

DEPARTMENT OF OTOTOLOGY:

D. C. GAMBLE, M. D. M. D. JONES, M. D.

DEPARTMENT OF OPHTHALMOLOGY:

H. WOLFNER, M. D.

DEPARTMENT OF ORTHOPEDIC SURGERY:

FRANK P. JOHNSON, M. D.

DEPARTMENT OF GYNECOLOGY:

R. C. ATKINSON, M. D. G. HOMAN, M. D.
F. C. AMEISS, M. D. T. E. HOLLAND, M. D.

DEPARTMENT OF NERVOUS DISEASES:

M. C. CARR, M. D.

DEPARTMENT OF DISEASES OF CHILDREN:

A. N. RAVOLD, M. D.

DR. E. H. HIGBEE, *Resident Physician.*

ANNOUNCEMENT.

The second annual term of instruction will begin Monday, the 25th of October, 1886, and continue uninterrupted in six week courses until Saturday, the 2d of July, 1887.

Though it is recommended that students enter at the commencement of a course, yet they will be received at any time during the term.

The object of the school is to give practitioners of medicine and recent graduates special facilities and advantages in the study, observation and treatment of clinical cases as they are presented at the dispensary and in the various hospitals to which the Professors have access.

The Faculty refers with a great deal of satisfaction, and in evidence that the material for teaching purposes is ample, to the report found in another part of this announcement, of the cases examined and treated during the past ten months of the existence of the Polyclinic, which for variety, number and interest excelled the anticipations of even the most sanguine. Abundant material was thus not only furnished for teaching purposes, but students were enabled to personally examine and prescribe for and even operate on rare and important cases. Each month has marked an increase in the number applying for relief at the Polyclinic, until in all the departments the variety of the cases answers all the requirements for efficient teaching. And it must be understood that the advantages to be derived from this vast clinical material in the way of increasing medical knowledge and experience belong exclusively to the pupils of this school.

This institution being intended for graduates only, does

not clash in its objects or interests with those colleges whose instruction terminates with the graduation of the student.

It is rather supplemental to them, commencing where they leave off, affording the student an opportunity to practically test, under efficient instructors, the theories and teachings given before. But it is to the practitioner of few or many years, desiring to learn the latest facts in pathology, and to witness the most recent modes of treatment and methods of operating that this school is especially helpful; and to those preparing themselves for the practice of specialties, here opportunity is afforded of becoming peculiarly well qualified.

Its commodious building, situated at the southwest corner of Jefferson and Lucas Avenues, is convenient to street railways running in every direction, affording easy access from all parts of the city and easy transit to the hospitals where clinics are held. The structure has been carefully planned for the purposes of the school, and besides the general reading and waiting rooms, various clinic rooms and a large amphitheatre, all of which are on the first floor, hospital accommodations have been provided in the upper story for patients from a distance or those who must be cared for after surgical operations. These hospital rooms have been extensively used for the above purposes from the opening of the institution. The requisite conveniences for anatomical and pathological studies are abundantly provided for.

The resident physician assigns to their proper departments the patients who apply at the Dispensary, and he also has general supervision and control of the domestic management of the hospital. Six hours daily will be occupied by the clinics, which will be so conducted by the professors, for purposes of demonstration and instruction, that the

greater part of each day will be occupied at the school, except that Friday and Saturday afternoons will be devoted to cases at the City Hospital and elsewhere.

Several of the professors are consulting physicians or surgeons, in their different specialties, to the City Hospital, lecturers to the Training School for Nurses, and are connected with the Augusta Free Hospital for Children, and other hospitals in the city.

The plan of instruction in the various branches of Medicine and Surgery has been arranged as follows:—

PRACTICAL MEDICINE AND PRINCIPLES OF DIAGNOSIS.

PROFESSOR, P. GERVAIS ROBINSON, M. D.

ASSISTANTS, J. R. LEMEN, M. D., E. M. NELSON, M. D.

The instruction in this department will embrace the diagnosis and treatment of disease, accurate observation and the significance of symptoms. Each member of the class will have opportunities to examine patients at the clinic and observe for himself the symptoms described by the professor, and the modifications resulting from treatment. There will be a weekly clinic at the City Hospital.

SURGERY AND GENITO-URINARY DISEASES.

PROFESSOR H. TUHOLSKE, M. D.

ASSISTANTS, C. H. DIXON, M. D., L. T. RIESMEYER, M. D.

The surgical clinic is always abundantly supplied with material, both at the City Hospital and at the Polyclinic, and presents a great variety of surgical diseases, including diseases of the genito-urinary organs. Thus students have ample opportunity of familiarizing themselves with the use of the sound, endoscope and all important surgical instru-

ments. Members of the class may personally examine surgical cases, and in many instances carry out the treatment, practicing the application of various surgical appliances and antiseptic dressings.

Courses on *Operative Surgery* will be found of signal advantage. The students may repeat on the cadaver under the guidance of the Professor of Surgery typical and other operations, such as amputations, resections, herniotomies, tenotomies, resections of pylorus and of bowel, extirpation of thyroid, osteotomies, etc., and thus acquire the technical knowledge necessary to the operating surgeon.

In surgical anatomy opportunities will be furnished to those gentlemen who are desirous of receiving special instruction.

DISEASES OF THE SKIN.

PROFESSOR W. A. HARDAWAY, M. D.

ASSISTANT, F. R. EVERSOLE, M. D.

Practical instructions in the diagnosis and treatment of diseases of the skin will be given, and the clinical lectures will be illustrated by cases from the Polyclinic and from numerous finely colored drawings. Microscopical demonstrations of the anatomy of the skin and of the vegetable and animal parasites infesting it, will be made a special feature of the course.

DISEASES OF THE CHEST AND THROAT.

PROFESSOR W. C. GLASGOW, M. D.

ASSISTANTS, L. C. BOISLINIERE, JR., M. D., J. B. HEREFORD, JR., M. D.

In this department special clinics will be held three times a week. The principles and practice of physical diagnosis of the chest will receive special attention and the practice will be fully illustrated by selected cases of diseases of the heart and lungs. The clinics are especially rich in the dis-

eases of the upper air passages, affording full opportunities for the practical study of Laryngoscopy and Rhinoscopy. A course of special didactic lectures on diseases of the upper air passages will be given, illustrating in a practical manner the use of instruments and therapeutic appliances necessary for the modern treatment of these diseases.

DISEASES OF THE EAR.

PROFESSOR H. N. SPENCER, M. D.

CLINICAL ASSISTANTS, DR. D. C. GAMBLE, DR. M. D. JONES.

Instruction in this department will be of the most practical character. The anatomy of the ear will be exemplified on preparations and models. Attention will be paid to the methods of examining the ear, the use of instruments, and the therapeutical applications in the treatment of its diseases. The clinic always presents a large variety of cases.

DISEASES OF THE EYE.

PROFESSOR C. E. MICHEL, M. D.

ASSISTANT, H. L. WOLFNER, M. D.

The course on Ophthalmology will be thoroughly practical, commencing with a succinct demonstration of the anatomy of the eye. A well attended clinic affords ample material for operations and the study of the varied diseases of the eye, and, as the cases will be personally examined by each member of the class, accurate diagnostic experience can thus be gained. The methods of determining and correcting defects of refraction will be demonstrated, and as the adaptation of glasses will be of daily occurrence, familiarity with its details can be mastered. The practical use of the Ophthalmoscope first on artificial eyes and then for the examination of patients will form a prominent feature of the course. The Perimeter and all other modern appliances in ophthalmology will receive attention.

ORTHOPEDIC SURGERY AND JOINT DISEASES.

PROFESSOR A. J. STEELE, M. D.

ASSISTANT, DR. F. P. JOHNSON.

In this department will be taught the early diagnosis of deformities and joint troubles, and their treatment with special reference to their pathology.

Orthopedic appliances in their construction and adaptability will be so described and illustrated as to be readily understood. The preparation and application of plaster-of-Paris bandages in the treatment of joint diseases, spinal deformities, and club foot will be a feature of the course; the making of sole-leather splints, the method of giving special exercises, and the mode of employing massage will be shown. Tenotomies and osteotomies for the relief of deformities will be done before and, as opportunity offers, by the class.

DISEASES OF WOMEN.

PROFESSOR G. J. ENGELMANN, M. D.

ASSISTANTS:

R. C. ATKINSON, M. D.

T. E. HOLLAND, M. D.

F. C. AMEISS, M. D.

G. HOMAN, M. D.

The abundance and variety of clinical material offering in this department affords the best possible opportunity for the practical study of diseases of women; and for the benefit of the general practitioner especial attention is given to that class of cases which are most frequently observed in family practice. The gentlemen individually will be afforded opportunity of examining and treating patients, and of witnessing the various late modifications of operations upon the utero-vaginal tract.

Abdominal sections will be performed, and physicians in attendance will be enabled to see the operation by special invitation.

NERVOUS DISEASES.

PROFESSOR H. W. HERMANN, M. D.
ASSISTANT, M. C. CARR, M. D.

Instruction in diseases of the brain, spinal cord and peripheral nerves will be given on three days in the week.

The methods and instruments of precision used in testing the functions of the nervous system will be made familiar by their practical application. In the study of localized affections the anatomy of the parts will be reviewed and illustrated by preparations, models and drawings. The number of interesting cases furnished by the Polyclinic will be amplified by cases in the City Hospital and St. Louis Insane Asylum. Members of the class will have frequent opportunities of examining patients and making the diagnosis.

DISEASES OF CHILDREN.

PROFESSOR CHARLES E. BRIGGS, M. D.
ASSISTANT, AMAND N. RAVOLD, M. D.

The diseases incident to childhood will be discussed systematically and their relations shown to growth and development, with practical lessons bearing upon Therapeutics, as modified by the natural conditions of this class of patients. A special hospital for children has recently been erected, and is open to the teacher in this department.

FEES.

One course of six weeks in all the departments, -	\$100 00
One course of twelve weeks " " "	150 00
One course of eighteen weeks " " "	200 00
One course, whole year, " " "	225 00
Single department, six weeks, -	25 00
Two departments, six weeks, -	45 00
Three departments, six weeks, -	60 00
Each additional department, six weeks, -	10 00
Special classes in Surgical Anatomy, term of six weeks—limited to four members (\$25.00 each), -	100 00

TICKETS AND CERTIFICATES.

Members of the class taking full or partial courses will be furnished with tickets by the Secretary at the opening of the course, and with certificates of attendance at the close of the course.

Board can be engaged in the vicinity of the school for from \$4.00 to \$7.00 per week.

REPORT OF THE POLYCLINIC

For the first ten months, commencing August 1st, 1885,
and ending May 31st, 1886.

MEDICAL CLINIC.

Albuminuria.....	4	Jaundice.....	1
Alcoholism.....	1	Lithemia.....	3
Anemia.....	27	Liver, congestion of.....	1
Bronchitis.....	16	Lumbago.....	4
Cephalalgia.....	8	Migraine.....	2
Cholera Morbus.....	1	Myalgia.....	12
Constipation.....	28	Neuralgia.....	14
Debility.....	6	Nephritis.....	4
Diabetes insipidus.....	2	Neurasthenia.....	9
Diarrhœa.....	11	Nervous.....	5
Dysentery, acute.....	2	Rheumatism.....	8
Dysentery, chronic.....	2	" chronic.....	11
Dyspepsia.....	65	Phthisis.....	7
Erysipelas.....	1	Pregnancy.....	1
Fever, intermittent.....	52	Purpura Hemorrhagica....	1
" chronic.....	6	Tenia Solium.....	5
" remittent.....	12	Salivation.....	1
" ephemeral.....	1	Syphilis.....	3
Glands, enlarged.....	2	No diagnosis.....	24
Heart Disease.....	4		

SURGERY.

Abscess.....	13	Hernia, oblique.....	6
Angioma.....	2	" double.....	2
Bronchocele.....	2	" direct.....	3
Callositas.....	5	" femoral.....	1
Caries, Scapula.....	1	Hemorrhoids.....	5
" Spine.....	1	Lymphadenitis.....	3
Carbuncle.....	6	Lymphangitis.....	2
Contusions.....	36	Parotitis.....	2
Cellulitis.....	10	Paronychia.....	8
Enchondroma.....	1	Tonsils excised.....	2
Epistaxis.....	2	Tumors—	
Excision (elbow).....	1	Adenoid.....	2
Fistula, anal.....	2	Carcinoma.....	1
" mental.....	1	Cysts Sebaceous.....	2
Fissure, anal.....	3	Epithelial.....	4
" nipple.....	1	Lipoma.....	3
Fractures—		Myomata.....	1
Clavicle.....	1	Sarcoma.....	1
Fibula.....	1	Tuberculosis, local.....	4
Metacarpus.....	2	Ulcers, lupus.....	2
Nasal Bones.....	1	" rectal.....	2
Radius.....	1	" varicose.....	5
Phalanges.....	3	Varicose Veins.....	3
Tibia.....	1	Wounds, contused.....	8
Furunculus.....	3	" gunshot.....	2
Ganglion.....	2	" incised.....	8
Glands, enlarged.....	5	" lacerated.....	15
" suppurating.....	5		

GENITO-URINARY SURGERY.

Balanitis.....	7	Cystitis, chronic.....	5
Bubo, indolent.....	3	Epispadias (operation).....	1
" suppurating.....	8	Epididymitis.....	5
Castration.....	1	False passage.....	1
Circumcision.....	4	Hydrocele.....	3
Chancroids.....	16	Impotence.....	2
Condylomata.....	4	Orchitis, gonorrhœal.....	3
Cystitis, acute.....	3	Orchitis, syphilitic.....	1

Orchitis, traumatic	2	Urethritis, acute.....	3
Phagedena.....	1	" acute gonorr-	
Prostatitis.....	4	hœal.....	35
Spermatorrhœa	10	Urethritis, chronic.....	18
Stricture, urethral.....	9	Urethral Abscess.....	1
Syphilis, primary.....	13	Urethrotomy, internal....	2
" secondary and		Varicocele	2
tertiary.....	27		

DERMATOLOGICAL DEPARTMENT.

The number of patients in the Dermatological Department has been unexpectedly large and unusually interesting.

As will be seen from the following general summary, diseases of widely differing characters have been exhibited to the class, representing not only the ordinary cutaneous affections, but also some of the rarer forms. Thus, to select at random from the clinic book, there will be found recorded, eczema; lichen planus; the various types of cutaneous syphilis, both hereditary and acquired; the animal and vegetable parasitic disorders, such as scabies, phthiriasis, tinea tonsurans et circinata, tinea versicolor and tinea sycosis; acne; rosacea; herpes zoster; rôtheln and varicella.

Therefore it will be seen at a glance that ample opportunity has been afforded for the study of differential diagnosis and methods of treatment.

DEPARTMENT OF CHEST AND THROAT.

Rhinitis, sub-acute.....	10	Pharyngitis, acute.....	4
" hypertrophic....	25	" catarrhal.....	17
" atrophic	12	" atrophic.....	4
" purulent	8	" follicular.....	10
" syphilitic.....	5	" lateralis.....	15
Nasal Polypus.....	2	Pharyngeal ulcer.....	4
" hemorrhage.....	1	Leucoplaxia	1
Sarcoma of nose.....	1	Inflammation palate.....	3
Vaso-motor catarrh.....	2	Tonsillitis, acute parench..	6
Naso-pharyngeal catarrh..	18	" " follic	11
Adenoid growths naso-		" hypertrophic.....	22
pharynx.....	2	Mycosis of tonsil.....	1

Cyst of tonsil.....	1	Emphysema.....	3
Laryngitis Catarrhalis.....	20	Asthma.....	13
" sub-acute.....	45	Laryngeal Asthma.....	14
" acute.....	2	Pneumonia, chronic.....	1
" granular.....	10	Pleurisy, fibrinous.....	2
" syphilitic.....	4	" chronic, with ef-	
Laryngeal phthisis.....	5	fusion.....	1
Epithelioma of larynx.....	1	Pleurodynia.....	11
Spasm of glottis.....	3	Phthisis.....	26
Hooping cough.....	1	Tuberculosis.....	6
Chorea of larynx.....	1	Heart—hypertrophy.....	2
Bronchocele.....	3	" dilatation.....	8
Abscess Sub. Max. gland..	2	" valv. disease.....	20
Glandular swellings.....	6	" irritable.....	4
Tracheo bronchitis.....	6	" functional disturb-	
Bronchitis, chronic.....	10	ance.....	14
Emphysema, Bronchitis		Pericarditis.....	1
and Asthma.....	10	Aneurism of Aorta.....	1
Emphysema and bronchitis	15	Dilatation of Aorta.....	1
Total number of cases.....			408
Total number of visits.....			2,481

OTOLOGICAL DEPARTMENT.

EXTERNAL EAR.

Inflammation of Mastoid		Otitis Externa Diffusa,	
Cells.....	2	(acute).....	3
Furunculosis.....	5	Otitis Externa Diffusa,	
Exostosis of Meatus.....	2	(chronic).....	5
Eczema of Auricle.....	5	Eczema of Meatus.....	5
Foreign bodies.....	4	Contusion of Auricle.....	1
Keratosis Obturans.....	2	Ulceration of dermoid lay-	
Impacted Cerumen.....	18	er of Membrana tympani	1
Aspergillus Nigricans.....	2		

MIDDLE EAR.

Acute Suppurative Inflam-		Acute Catarrh with effu-	
mation.....	24	sion.....	5
Chronic Suppurative In-		Chronic Catarrh (asecre-	
flammation.....	27	tory).....	45
Acute Catarrh.....	4	Chronic Catarrh (secretory)	3

Chronic Catarrh with calcareous deposits.....	4	Chronic Catarrh with marked Tinnitus and Vertigo..	36
Chronic Catarrh with adhesions.....	8	Syphilitic Ozena with deafness.....	1

INTERNAL EAR.

Total deafness from concussion.....	1	Absolute deafness from Cerebro-Spinal Meningitis.....	2
Deaf Mutism.....	3		

OPERATIONS.

Opening Mastoid Cells.....	1	Paracentesis of Membrana Tympani.....	5
Post-Auricular Abscess... ..	2	Extraction of for'gn bodies	4
Removal of Polypi.....	8		

REPORT OF OPHTHALMIC CLINIC.

Aphakia (Traumatic).....	1	Nasal duct, stricture of, and fistula.....	5
Amblyopia (Anæmic).....	1	Neuritis, optic.....	3
Abscess of Cornea.....	1	Ophthalmia, purulent.....	3
Atropine Mydriasis.....	1	Panophthalmitis.....	1
Cataract.....	17	Pterygium.....	2
Chalazion.....	4	Phthisis Bulbi.....	4
Ciliary Blepharitis.....	10	Paralysis Ext. Rectus (specific).....	1
Choroiditis.....	3	Paresis Inferior Rectus ...	1
Conjunctivitis, acute.....	26	Puncta, obstruction of....	2
Entropium.....	2	Retinitis, albuminuric.....	1
Ectropium.....	1	Synchysis.....	1
Echymosis of conjunctiva	1	Symblepharon.....	1
Eczema of lids.....	2	Strabismus convergent....	11
Foreign body in globe, cornea, etc.....	15	Synechia (posterior).....	2
Glaucoma.....	3	Staphyloma, cornea.....	2
Granulations (Hypertrophic) and Pannus.....	6	Trachoma.....	1
Hyalitis.....	1	Trichiasis.....	3
Hordeolum.....	1	Tumor of iris (specific)....	1
Iritis.....	6	Ulcer of cornea.....	8
Injury to cornea.....	3	Hyperopia.....	8
Keratitis.....	3	Astigmatism.....	5
Leucoma (central).....	9	Presbyopia.....	7

Myopia.....	3	Errors of accommodation	
Insufficiency of Recti In-		or refraction (unfinished	
terni.....	11	tests).....	24

OPERATIONS.

Strabismus.....	4	Entropium	1
Chalazion, removal of....	3	Iridectomy.....	8
Canaliculus, Lachry mal, di-		Iridotomy.....	1
vision of.....	6	Pterygium.....	1
Cataract.....	10	Resection globe.....	3
Exenteratio bulbi.....	1	Symblepharon.....	1
Electrolysis (Trichiasis)....	2		

ORTHOPEDIC SURGERY.

Anchylosis, false, of ankle.	1	Knee Joint, foreign body in	1
“ “ elbow	2	Knock-knee, genu valgum,	
“ “ knee..	1	single.....	1
Ankle Joint, acute disease		Knock-knee, genu valgum,	
of.....	2	double.....	2
Ankle Joint, chronic dis-		Metatarso-Phalangeal	
ease of.....	1	Joints, Inf. of.....	2
Ankle weak.....	1	Osteo Arthritis, knee.....	1
Bow-leg.....	3	Phalangeal Joints, inflam-	
Bursitis, acute.....	2	mation of.....	1
“ chronic.....	1	Rheumatic Arthritis.....	1
Club-foot, Equino varus... 1		Shoulder Joint, inflamma-	
“ pes clavus.....	1	tion of.....	2
Curvature, anterior of leg		Sprain of ankle.....	3
bones.....	1	“ knee.....	1
Elbow, chronic disease of.. 1		“ tarsus.....	1
Hip-joint disease, coxitis.. 4		“ wrist.....	2
“ “ hysterical	1	Spine, caries of, Potts' dis-	
Hallux Valgus, double.... 1		ease.....	4
Knee Joint, disease of,		Spine, rotary-lateral curva-	
acute.....	5	ture of.....	1
Knee Joint, disease of,		Tarsal Joints, inflammation	
chronic.....	5	of.....	1

In the way of operations, there have been performed Tenotomies, Linear Osteotomies, Exsections, Tappings, etc.

REPORT OF GYNECOLOGICAL CLINIC,

FROM OCTOBER 1ST, 1885, TO JUNE 1ST, 1886.

This clinic has developed in a very satisfactory manner. Upon an average twenty patients receive treatment daily, with a monthly attendance of 500.

All the varied forms of female pelvic disorders, uterine, ovarian and circum-uterine are represented.

The number of patients operated on is small, as the clinic has been but recently established, and all now seeking admission have been referred to the more favorable fall season for operation. We have had—

Emmet's operation.....	4	Uterine Myxomata.....	3
Perineorrhaphy	2	Urethral Cyst.....	1
Uterine Fibroids reduced by Electrolysis.....	2	Laparotomy.....	1

These operations, with the exception of one Perineorrhaphy were performed in the Hospital of the Post Graduate School, with perfect results in every instance, and recovery without unfavorable symptoms of any kind.

Abortions	2	Hematocele.....	1
Carcinoma Uteri.....	2	Hyperinvolution.....	1
Caruncula Urethræ.....	1	Infantile Uterus.....	1
Cellulitis, acute.....	9	Laceration of Cervix.....	48
Cellulitis, chronic.....	14	Laceration of Perineum.....	27
Condylomata Syphilitica..	1	Metritis.....	3
Cystitis.....	2	Oöphoritis.....	2
Cystocele.....	5	Pregnancies.....	7
Endocervicitis.....	6	Prolapsus Uteri.....	10
Endometritis	23	Pruritus Vulvæ.....	3
Endometritis Fungosa....	4	Salpyngitis.....	4
Epithelioma of Nipple....	1	Subinvolution.....	29
Fibromyomata.....	3	Urethral Cyst.....	1
Flexions—		Vaginitis.....	4
Ante.....	13	Versions—	
Retro.....	5	Ante.....	24
Right Lateral.....	2	Retro.....	20
Left Lateral.....	1	Right Lateral.....	1
Gonorrhœa, acute.....	2	Left Lateral.....	2
“ chronic.....	1		

NERVOUS DISEASES.

Alcoholism, chronic.....	2	Myalgia.....	2
Anæmia.....	3	Neuralgia.....	5
Aphasia.....	2	" intercostal.....	1
Atrophy, progressive muscular.....	1	" occipital.....	1
" traumatic.....	3	Neurasthenia.....	11
Cephalalgia.....	18	Opium addiction.....	1
Chorea.....	5	Paralysis Agitans.....	2
Diplopia.....	1	" facial.....	5
Epilepsy.....	7	" hypoglossal.....	1
Hemiplegia.....	7	" of leg.....	2
Hemichorea.....	1	" of palate.....	1
Heart disease.....	4	Poliencephalitis.....	3
Hyperæmia, meningeal.....	1	Prurigo, nervous.....	1
Hypochondriasis.....	2	Rheumatism.....	2
Hysteria.....	1	Rheumatic Arthritis.....	2
Insomnia.....	3	Sciatica.....	6
Idiocy.....	2	Senility.....	1
Lateral Columns, sclerosis of.....	1	Spermatorrhœa.....	3
Lead Palsy.....	1	Spinal irritation.....	1
Lumbago.....	3	Spasm, facial.....	2
Mania.....	1	" phrenic.....	1
Migraine.....	2	" spinal accessory..	1
Melancholia.....	5	Tabes dorsalis.....	2
Meningitis.....	2	Tremor.....	2
		Vertigo.....	7
		Urine, incontinence of....	1

DISEASES OF CHILDREN.

Adenitis.....	4	Cerebral irritation.....	1
Apthous.....	1	" hyperæmia.....	1
Anæmia.....	1	Chorea.....	1
Enuresis.....	2	Constipation.....	3
Ascaris Vermicularis.....	1	Contusion.....	1
Bronchitis, acute.....	30	Coryza.....	1
" chronic.....	2	Debility.....	2
Bronchocele.....	1	Dentition.....	2
Bow-legs.....	1	Dyspepsia.....	3
Cephalalgia.....	2	Diarrhœa, acute.....	10

Earache.....	1	Parotiditis	3
Eclampsia.....	2	Pertussis.....	16
Eczema.....	1	Pharyngo-rhinitis.....	1
" papulosum.....	1	Pharyngitis, acute.....	5
Erythema.....	1	" chronic.....	1
Faucial irritation.....	1	Poisoned.....	1
Frenum linguæ.....	1	Rachitis.....	2
" shortness of.....	1	Rhinitis	7
Fever, intermittent.....	3	Scrofula.....	1
Herpes.....	1	Stomatitis.....	2
Hyperidrosis.....	1	Syphilis, hereditary.....	2
Indigestion.....	5	Tinea circinata.....	1
Insomnia.....	3	Tonsillitis.....	11
Laryngitis.....	2	Tonsils, chronic enlarge- ment of.....	6
" with spasm.....	1	Tuberculosis.....	1
Malaria.....	19	Varicella.....	2
Meningitis, tubercular.....	1	Not determined.....	4
Night terror.....	1		
Otorrhœa.....	1		

DIRECTORY.

- DR. P. G. ROBINSON, 3411 Washington ave.
 DR. H. TUHOLSKE, Jefferson ave. cor. Lucas place.
 DR. W. A. HARDAWAY, 2303 Olive st.
 DR. W. C. GLASGOW, 2847 Washington ave.
 DR. H. N. SPENCER, 2725 Washington ave.
 DR. C. E. MICHEL, 2927 Washington ave.
 DR. A. J. STEELE, 2825 Washington ave.
 DR. G. J. ENGELMANN, 3003 Locust st.
 DR. H. W. HERMANN, 2330 Washington ave.
 DR. CHARLES E. BRIGGS, *Secretary*, 28th and Olive sts.

E. H. HIGBEE, M. D.
 2604 Lucas ave.

*For further information, address the Secretary, Dr. C. E. Briggs, corner
 Lucas and Jefferson aves., St. Louis, Mo.*

